

Hamurana Rd

Highway 33

**U15  
64.33**

Rongitakia Rd  
Te Wihana Rd

Ngareta Rd

Waenga St

Takinga St

Okawa Bay Rd

Okawa PI



U15-1000/64.32

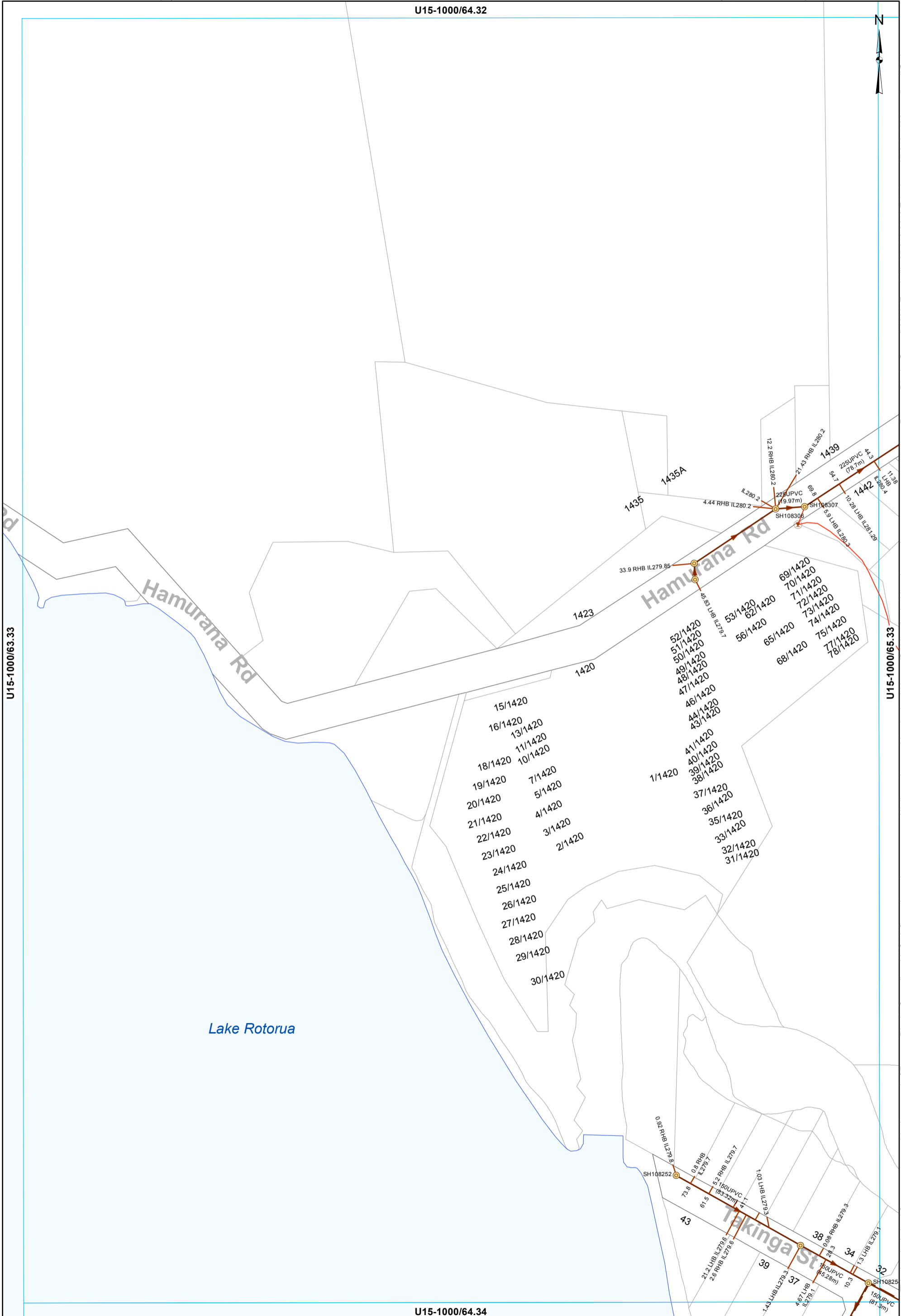

U15-1000/63.33

U15-1000/65.33

U15-1000/64.34

- Manhole
- Boundary Assembly
- Main line
- Rising main
- Service Line
- LPGP Service Line

**WASTEWATER SERVICES**  
**1:2000 @ A3 - (U15-1000/64.33)**

This data is derived from sources outside the control of Rotorua District Council and is for information only. Rotorua District Council 2006. Facsimile 07 348 3143 Telephone 07 348 4199 email mail@rdc.govt.nz