



Waste Water Asbuilt Sheet Index
MOUREA

Date: 5/2/2023

U15-1000/65.31

U15-1000/64.32

U15-1000/66.32

U15-1000/65.33



- Manhole
- Pump Station
- Grinder Pump Chamber
- LP Grinder Pump
- End of line - Capped end
- Air Valve
- Boundary Assembly
- Low Pressure Main
- Main line
- Rising main
- LPGP Service Line

WASTEWATER SERVICES
1:2000 @ A3 - (U15-1000/65.32)

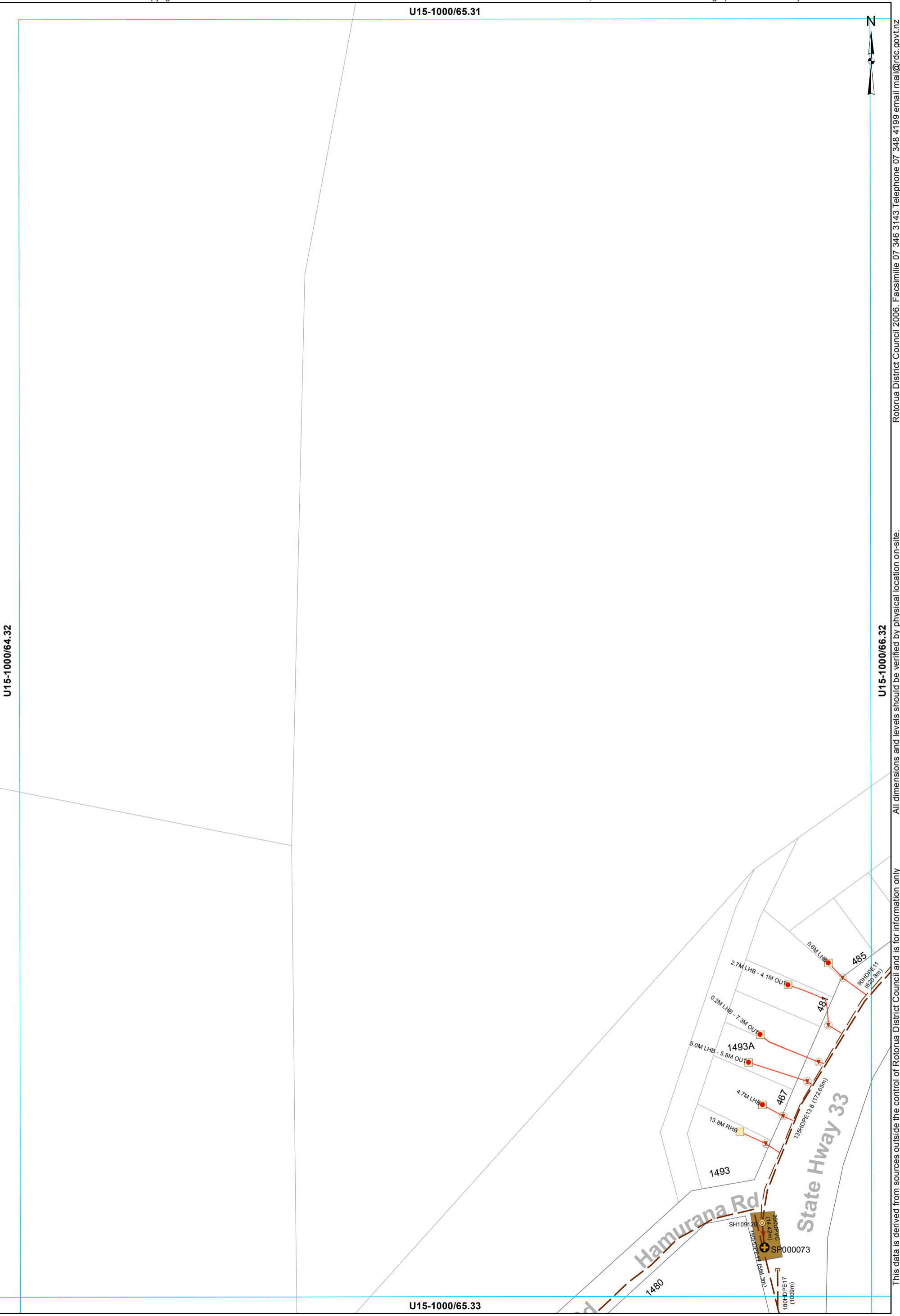

All dimensions and levels should be verified by physical location on-site. This data is derived from sources outside the control of Rotorua District Council and is for information only. Rotorua District Council 2006. Facsimile 07 346 3143 Telephone 07 348 4199 email mail@rdc.govt.nz

U15-1000/64.32

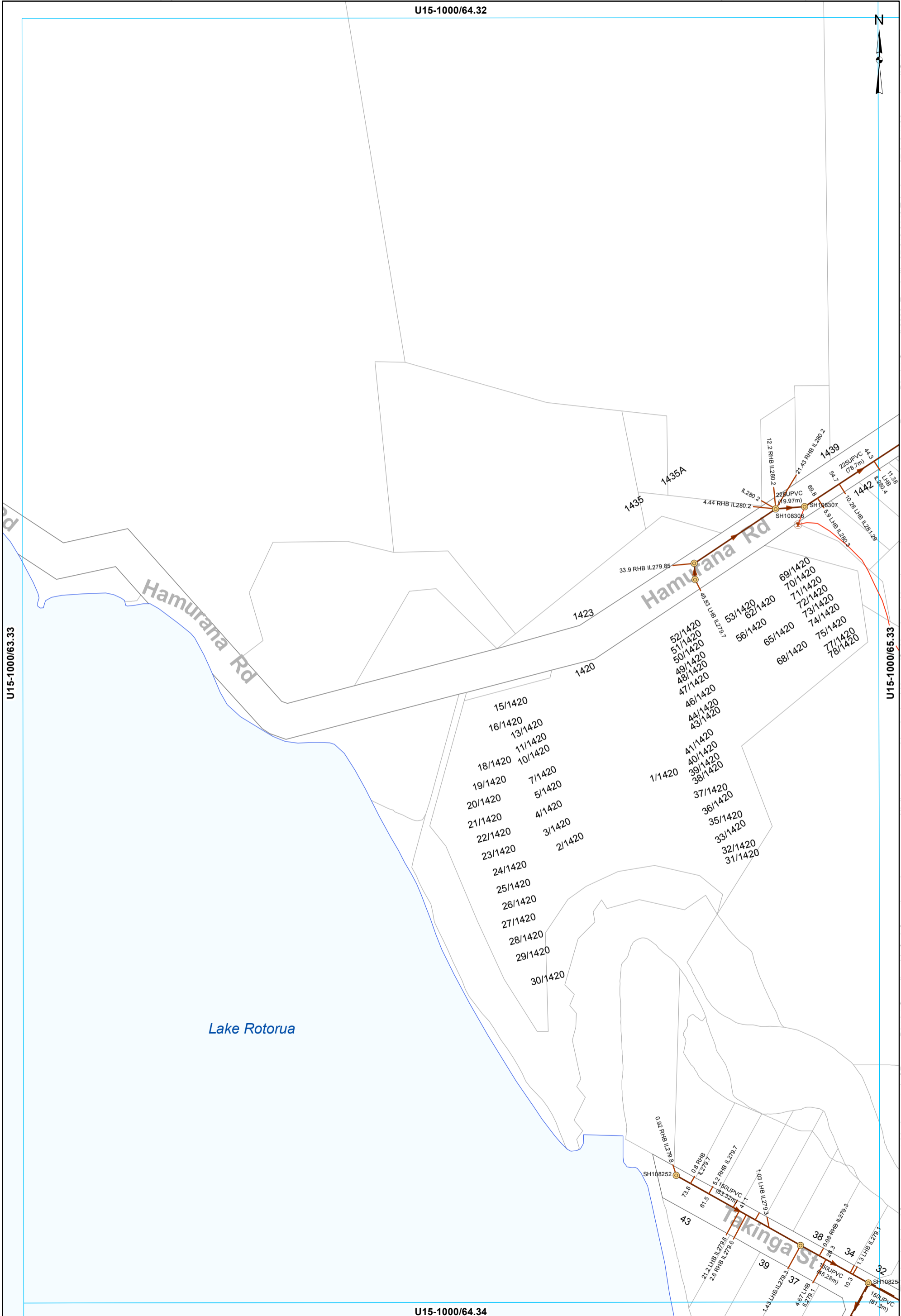

U15-1000/63.33

U15-1000/65.33

U15-1000/64.34

- Manhole
- Boundary Assembly
- Main line
- Rising main
- Service Line
- LPGP Service Line

WASTEWATER SERVICES
1:2000 @ A3 - (U15-1000/64.33)

This data is derived from sources outside the control of Rotorua District Council and is for information only. All dimensions and levels should be verified by physical location on-site. Rotorua District Council 2006. Facsimile 07 348 3143 Telephone 07 348 4199 email mail@rdc.govt.nz

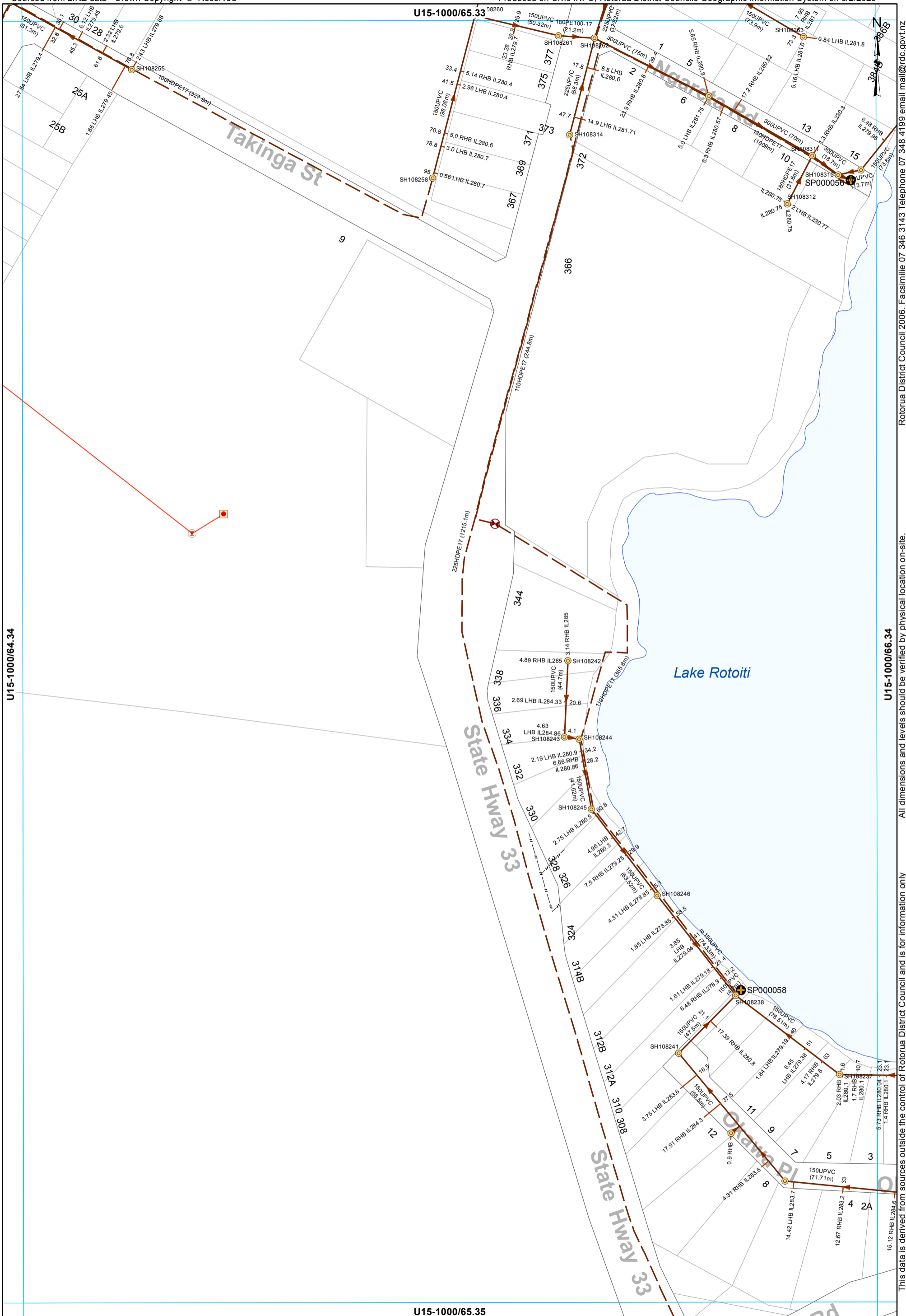

All dimensions and levels should be verified by physical location on-site. Rotorua District Council 2006. Facsimile 07 346 3143 Telephone 07 348 4199 email mail@rdc.govt.nz

- Manhole
- ⊕ Pump Station
- ⊞ Grinder Pump Chamber
- LP Grinder Pump
- ⊗ Air Valve
- ⊞ Boundary Assembly
- Main line
- - - Rising main
- - - Service Line
- - - LPGA Service Line

WASTEWATER SERVICES
1:2000 @ A3 - (U15-1000/65.34)