

Waste Water Asbuilt Sheet Index  
 NGONGOTAHA  
 Date: 5/2/2023

U15-1000/45.34

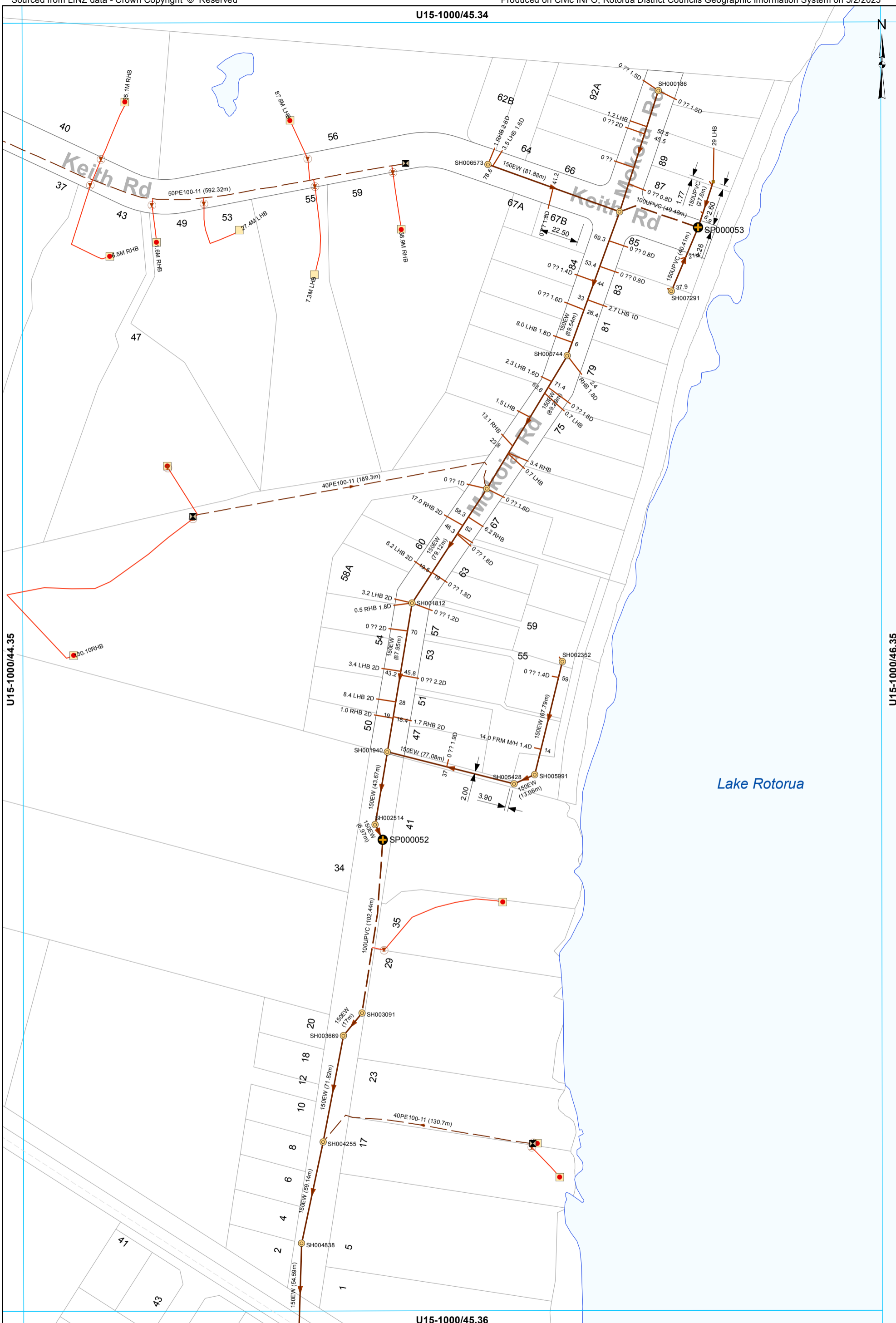

U15-1000/44.35

U15-1000/46.35

U15-1000/45.36

- Manhole
- ⊕ Pump Station
- Grinder Pump Chamber
- LP Grinder Pump
- Chamber - Inspection
- ⊠ Boundary Assembly
- ⊠ Clean Out Point
- Low Pressure Main
- Main line
- Rising main
- Service Line
- LPGP Service Line

**WASTEWATER SERVICES**  
1:2000 @ A3 - (U15-1000/45.35)

This data is derived from sources outside the control of Rotorua District Council and is for information only

Rotorua District Council 2006. Facsimile 07 346 3143 Telephone 07 348 4199 email mail@rdc.govt.nz

U15-1000/44.35

U15-1000/43.36

U15-1000/45.36

Rotorua District Council 2006. Facsimile 07 346 3143 Telephone 07 348 4199 email mail@rdc.govt.nz  
This data is derived from sources outside the control of Rotorua District Council and is for information only  
All dimensions and levels should be verified by physical location on-site.

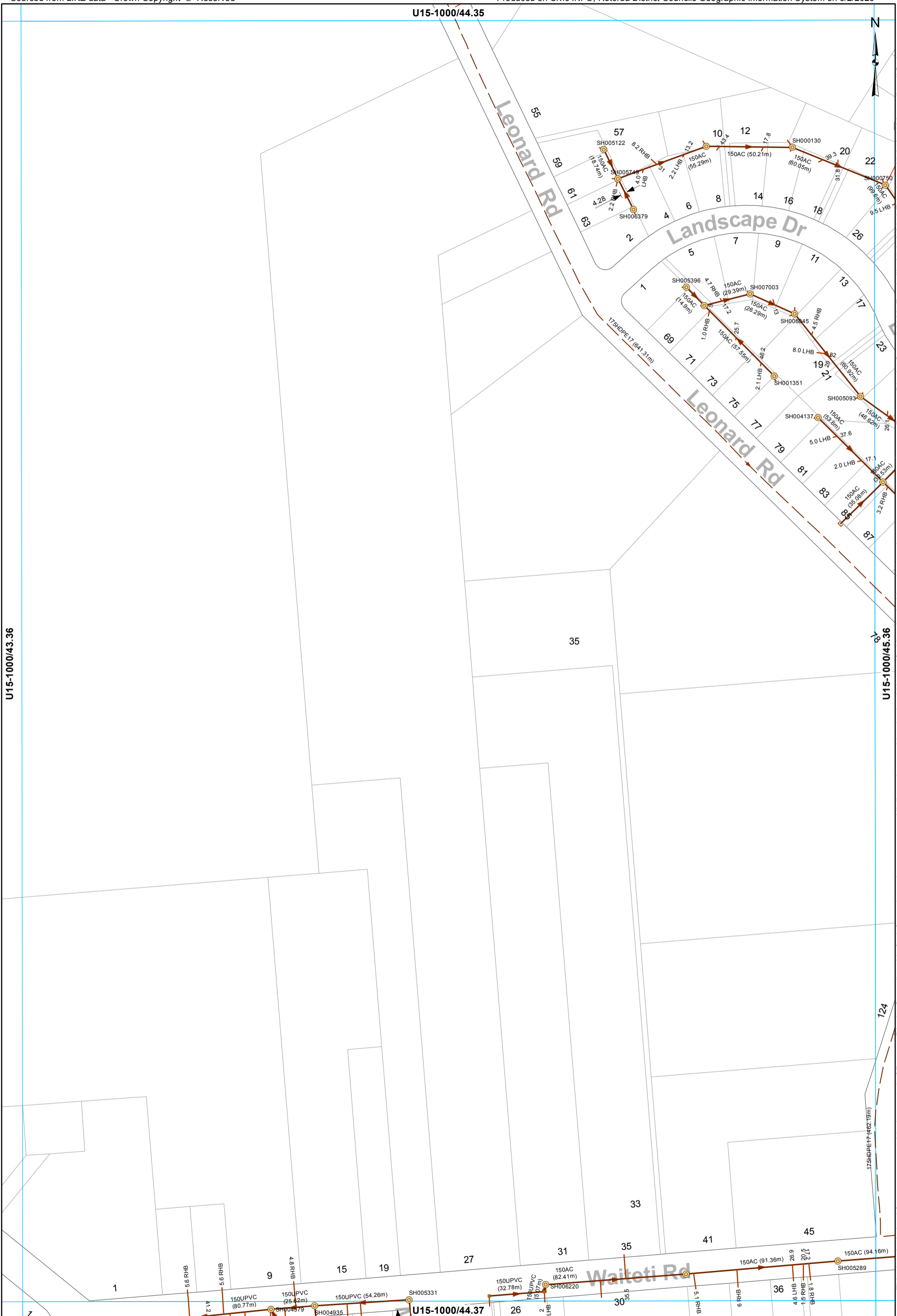

- Manhole
- Grinder Pump Chamber
- Chamber - Inspection
- End of line - Capped end
- ⊕ Boundary Assembly
- ⊘ Isolating Valve
- Low Pressure Main
- Main line
- Service Line
- LPG Service Line

**WASTEWATER SERVICES**  
**1:2000 @ A3 - (U15-1000/44.36)**

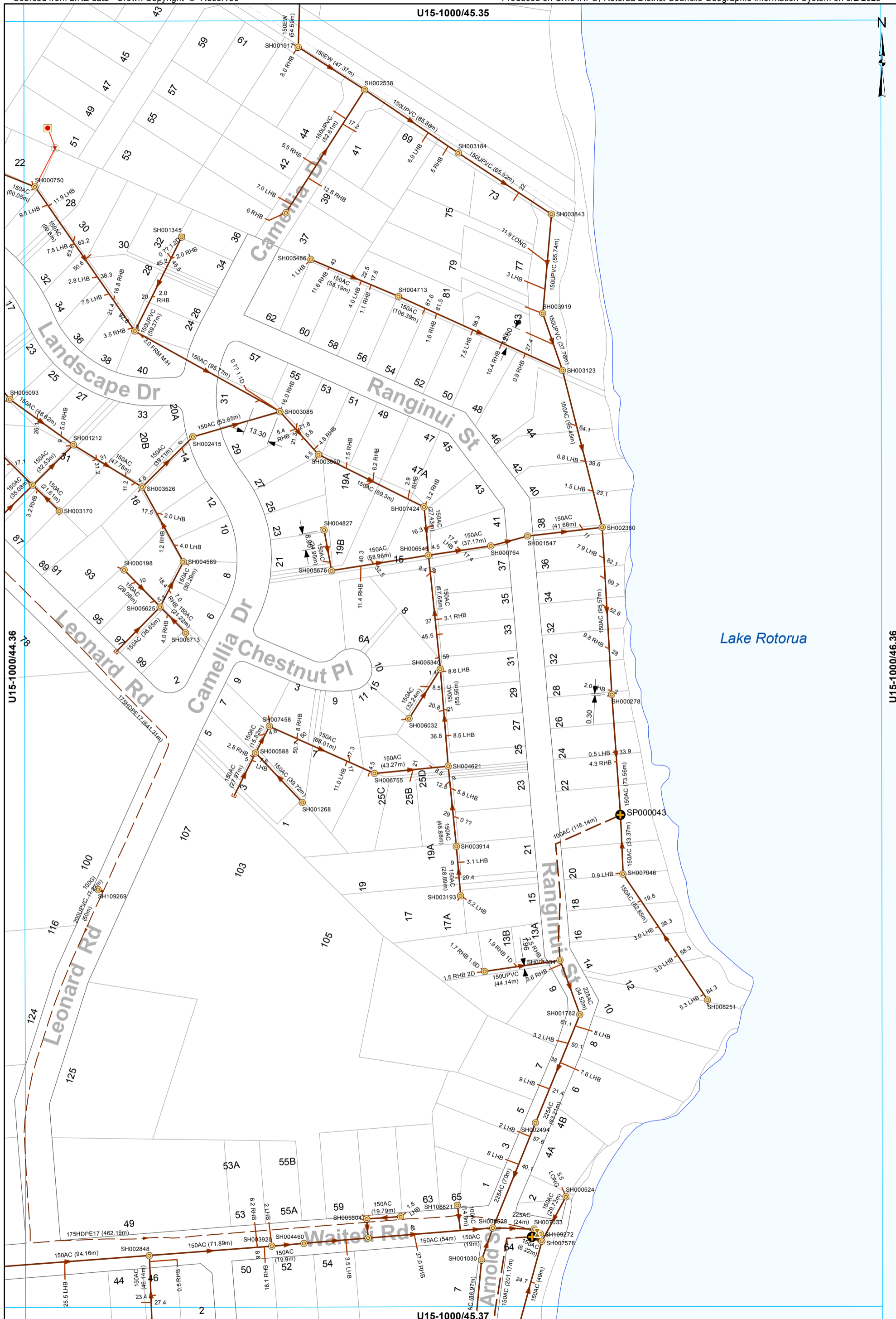

- Manhole
- Pump Station
- Grinder Pump Chamber
- LP Grinder Pump
- End of line - Capped end
- ⊗ Boundary Assembly
- ⊗ Isolating Valve
- Low Pressure Main
- Main line
- Rising main
- Service Line
- LGP Service Line

**WASTEWATER SERVICES**  
**1:2000 @ A3 - (U15-1000/45.36)**

U15-1000/44.36 U15-1000/45.35 U15-1000/45.37  
 All dimensions and levels should be verified by physical location on-site.  
 Rotorua District Council 2006. Facsimile 07 346 3143 Telephone 07 348 4199 email mail@rdc.govt.nz

U15-1000/42.36



U15-1000/41.37

U15-1000/43.37

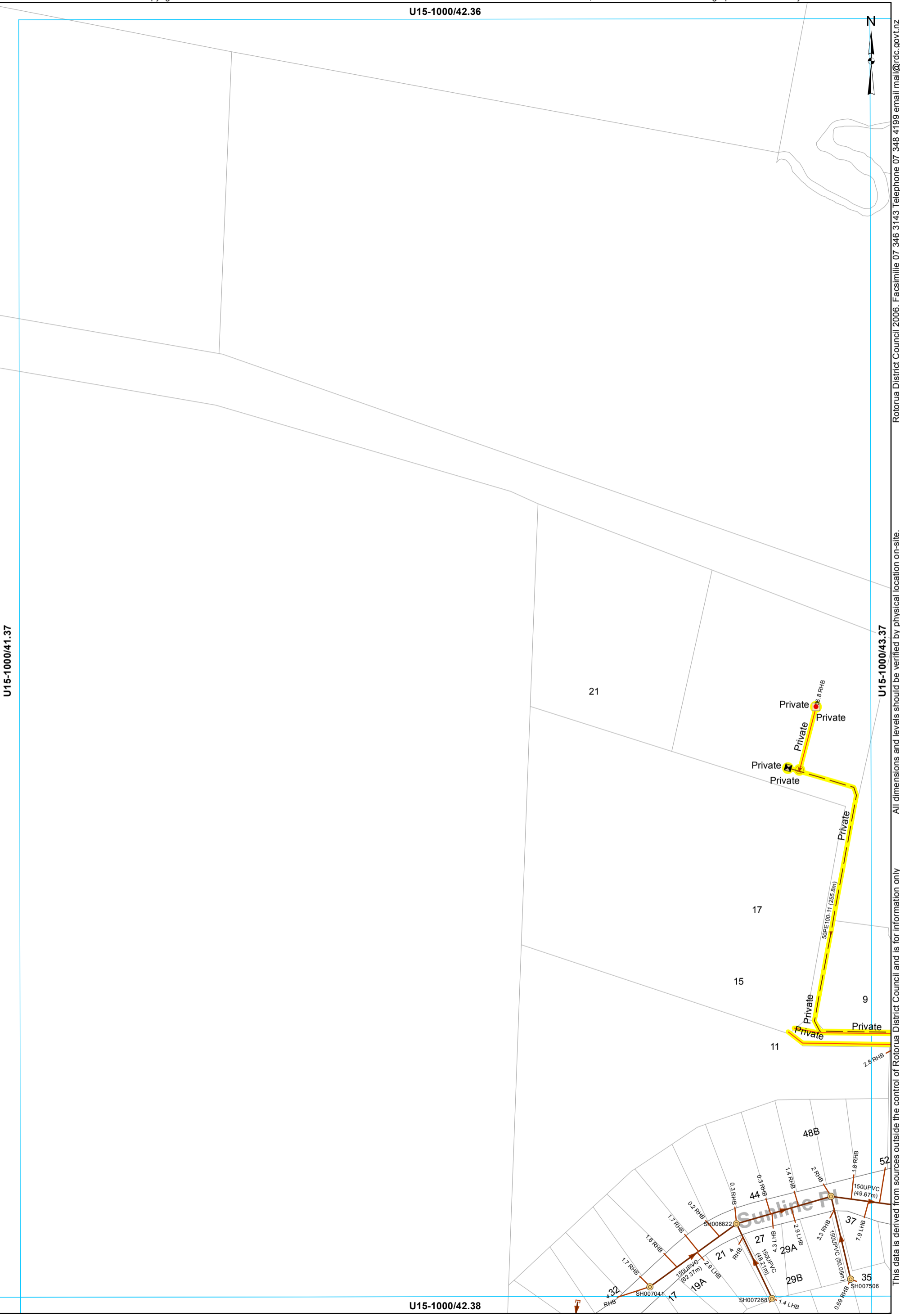

- Manhole
- Grinder Pump Chamber
- LP Grinder Pump
- ┘ End of line - Capped end
- ⊠ Boundary Assembly
- ⊠ Clean Out Point
- Private Asset
- ▬ Private Asset
- Low Pressure Main
- Main line
- Service Line
- LPGP Service Line

U15-1000/42.38

**WASTEWATER SERVICES**  
**1:2000 @ A3 - (U15-1000/42.37)**

All dimensions and levels should be verified by physical location on-site. Rotorua District Council 2006. Facsimile 07 346 3143 Telephone 07 348 4199 email mail@rdc.govt.nz

U15-1000/43.36



Rotorua District Council 2006. Facsimile 07 346 3143 Telephone 07 348 4199 email mail@rdc.govt.nz

U15-1000/42.37

U15-1000/44.37

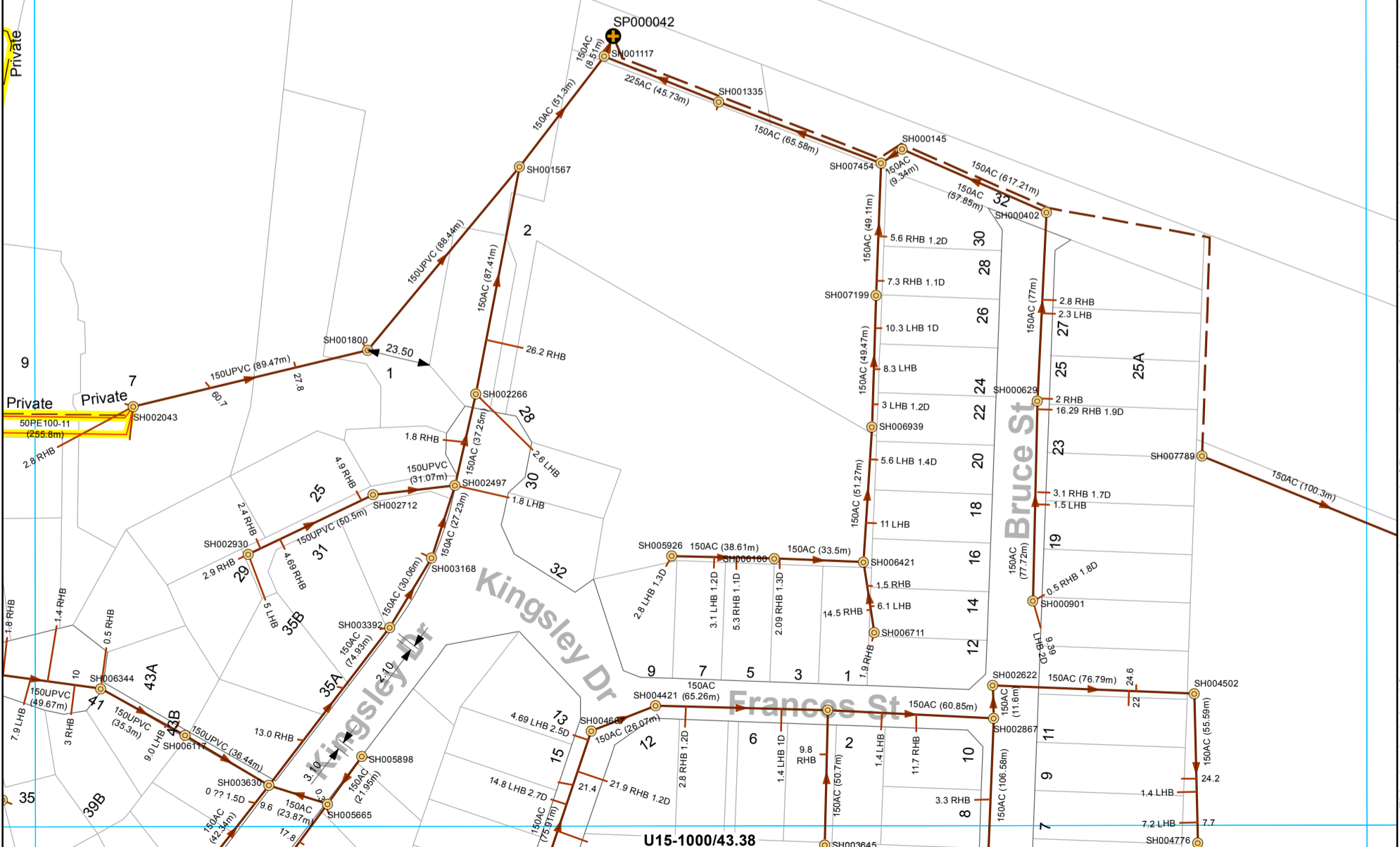

- Manhole
- Pump Station
- Private Asset
- Low Pressure Main
- Main line
- Rising main
- Service Line
- LPGP Service Line

**WASTEWATER SERVICES**  
1:2000 @ A3 - (U15-1000/43.37)

This data is derived from sources outside the control of Rotorua District Council and is for information only

U15-1000/43.38



- Manhole
- ⊕ Pump Station
- Chamber - Inspection
- End of line - Capped end
- Main line
- - - Rising main
- Service Line

**WASTEWATER SERVICES**  
**1:2000 @ A3 - (U15-1000/44.37)**

This data is derived from sources outside the control of Rotorua District Council and is for information only

Rotorua District Council 2006. Facsimile 07 346 3143 Telephone 07 348 4199 email mail@rdc.govt.nz



Lake Rotorua

- Manhole
- ⊕ Pump Station
- ▭ End of line - Capped end
- Low Pressure Main
- Main line
- Rising main
- Service Line

WASTEWATER SERVICES  
1:2000 @ A3 - (U15-1000/45.37)

This data is derived from sources outside the control of Rotorua District Council and is for information only. Rotorua District Council 2006. Facsimilie 07 346 3143 Telephone 07 348 4199 email mail@rdc.govt.nz



U15-1000/41.37



U15-1000/40.38

U15-1000/42.38

U15-1000/41.39

- Manhole
- ➔ Main line
- Service Line

**WASTEWATER SERVICES**  
1:2000 @ A3 - (U15-1000/41.38)



This data is derived from sources outside the control of Rotorua District Council and is for information only

All dimensions and levels should be verified by physical location on-site.

Rotorua District Council 2006. Facsimile 07 346 3143 Telephone 07 348 4199 email mail@rdc.govt.nz

U15-1000/42.37



- Manhole
- End of line - Capped end
- Main line
- - - Rising main
- Service Line

**WASTEWATER SERVICES**  
**1:2000 @ A3 - (U15-1000/42.38)**

This data is derived from sources outside the control of Rotorua District Council and is for information only

All dimensions and levels should be verified by physical location on-site.

Rotorua District Council 2006. Facsimile 07 346 3143 Telephone 07 348 4199 email mail@rdc.govt.nz

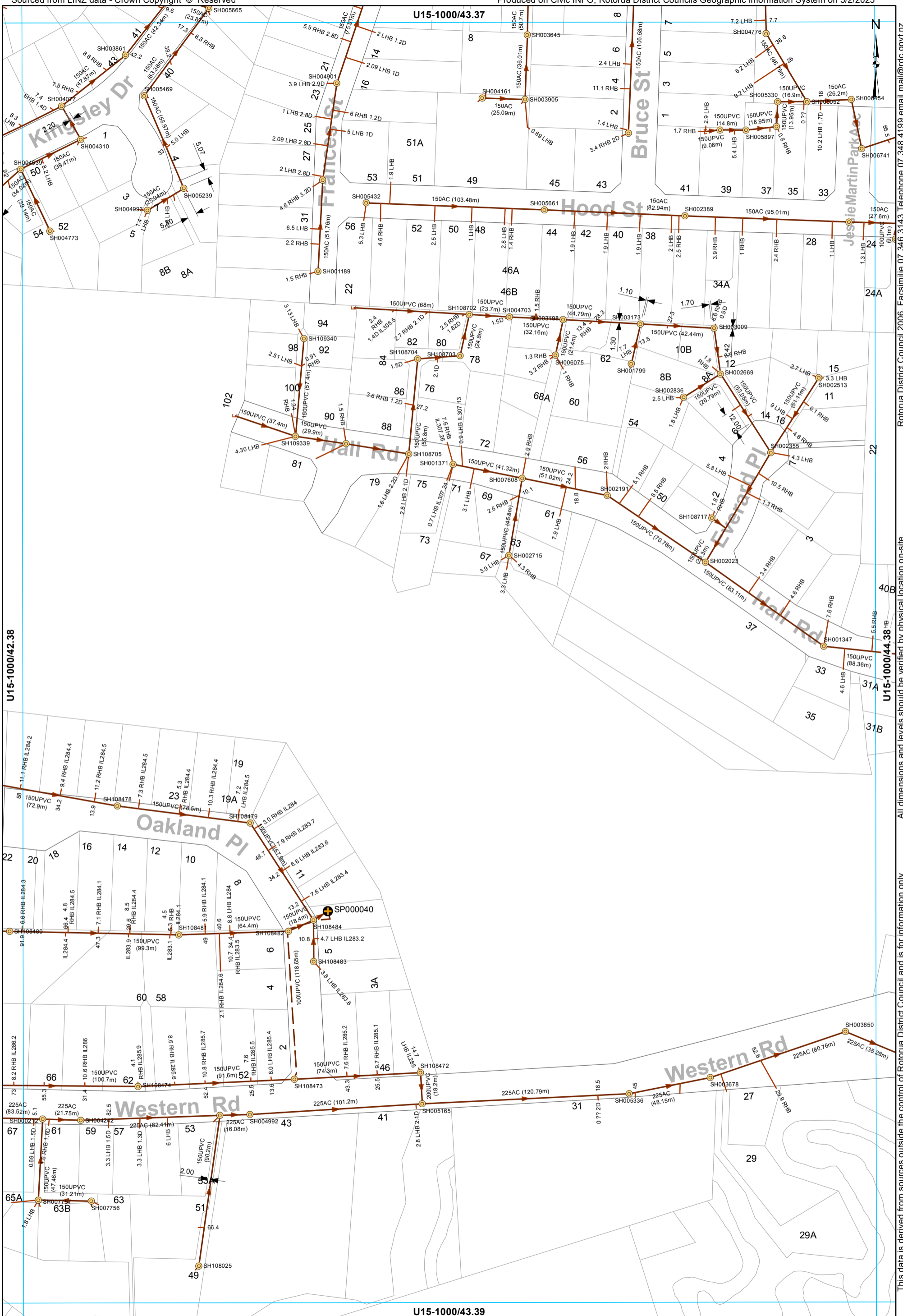

- Manhole
- ⊕ Pump Station
- └ End of line - Capped end
- Main line
- - - Rising main
- Service Line

**WASTEWATER SERVICES**  
**1:2000 @ A3 - (U15-1000/43.38)**

Rotorua District Council 2006. Facsimile 07 346 3143 Telephone 07 348 4199 email mail@rdc.govt.nz

All dimensions and levels should be verified by physical location on-site.

This data is derived from sources outside the control of Rotorua District Council and is for information only

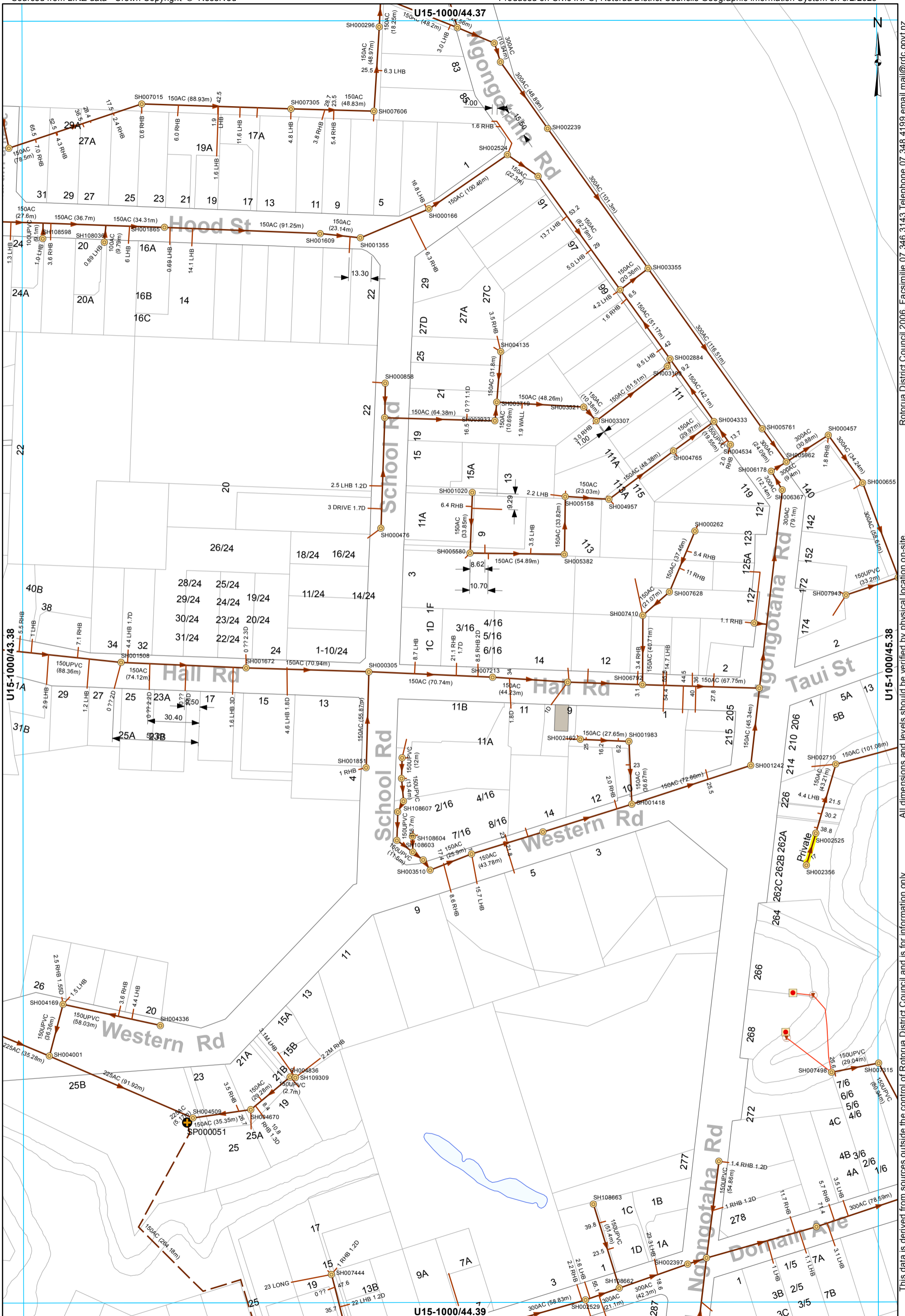

- Manhole
- Pump Station
- Grinder Pump Chamber
- LP Grinder Pump
- ▬ Boundary Assembly
- ▬ Private Asset
- ▬ Main line
- ▬ Rising main
- ▬ Service Line
- ▬ LPGP Service Line

**WASTEWATER SERVICES**  
**1:2000 @ A3 - (U15-1000/44.38)**

This data is derived from sources outside the control of Rotorua District Council and is for information only

All dimensions and levels should be verified by physical location on-site.

Rotorua District Council 2006. Facsimile 07 346 3143 Telephone 07 348 4199 email mail@rdc.govt.nz



Lake Rotorua

- Manhole
- ⊕ Pump Station
- Odour dome
- Inspection point
- Low Pressure Main
- Main line
- Rising main
- Service Line

WASTEWATER SERVICES  
1:2000 @ A3 - (U15-1000/45.38)

This data is derived from sources outside the control of Rotorua District Council and is for information only

Rotorua District Council 2006. Facsimile 07 346 3143 Telephone 07 348 4199 email mail@rdc.govt.nz

U15-1000/41.38

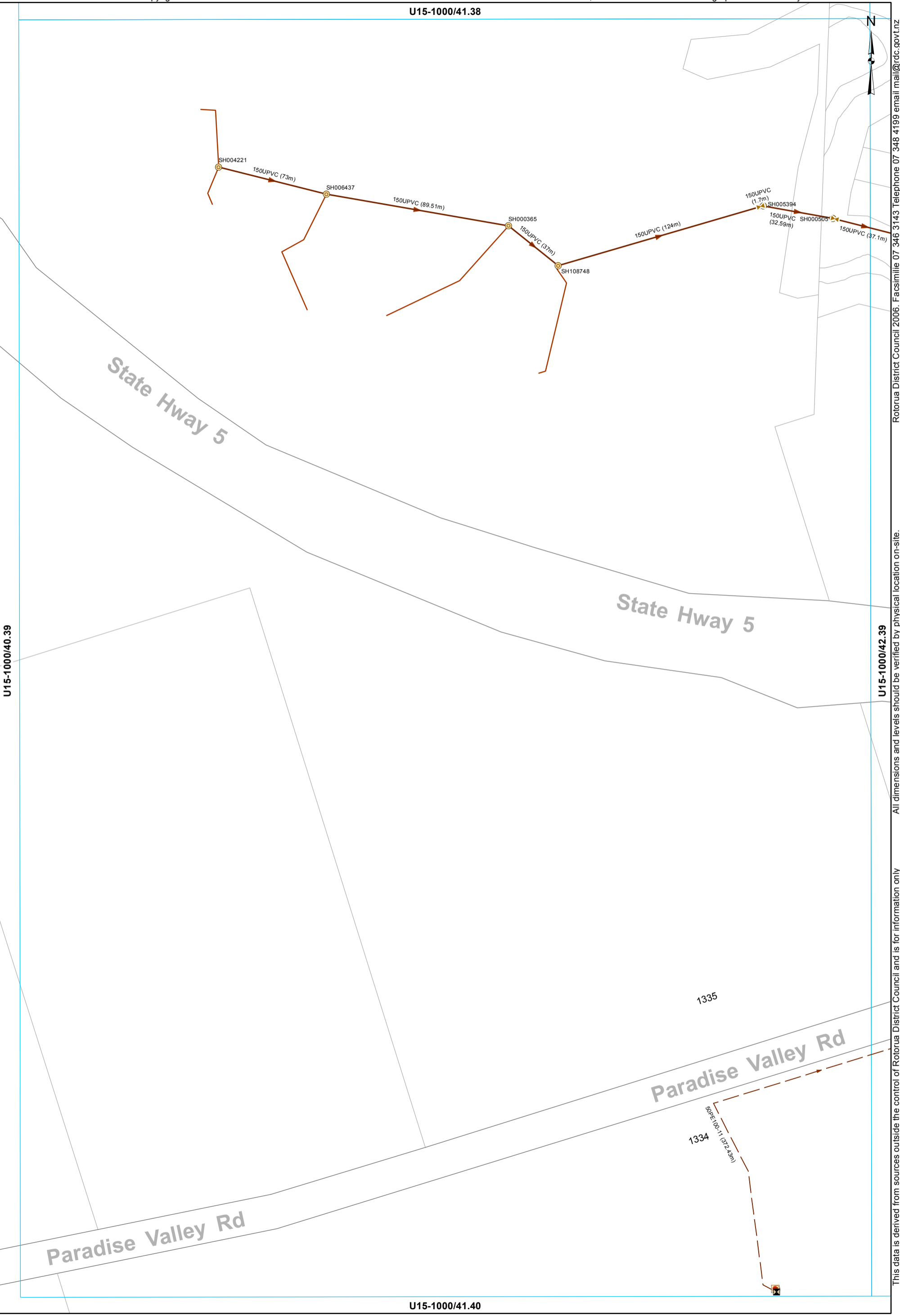

U15-1000/40.39

U15-1000/42.39

State Hwy 5

State Hwy 5

Paradise Valley Rd

Paradise Valley Rd

U15-1000/41.40

- Manhole
- Grinder Pump Chamber
- LP Grinder Pump
- ⊕ Boundary Assembly
- ⊠ Clean Out Point
- ⚡ Isolating Valve
- Low Pressure Main
- Main line
- Service Line
- LPGP Service Line

**WASTEWATER SERVICES**  
1:2000 @ A3 - (U15-1000/41.39)

All dimensions and levels should be verified by physical location on-site. Rotorua District Council 2006. Facsimile 07 346 3143 Telephone 07 348 4199 email mail@rdc.govt.nz

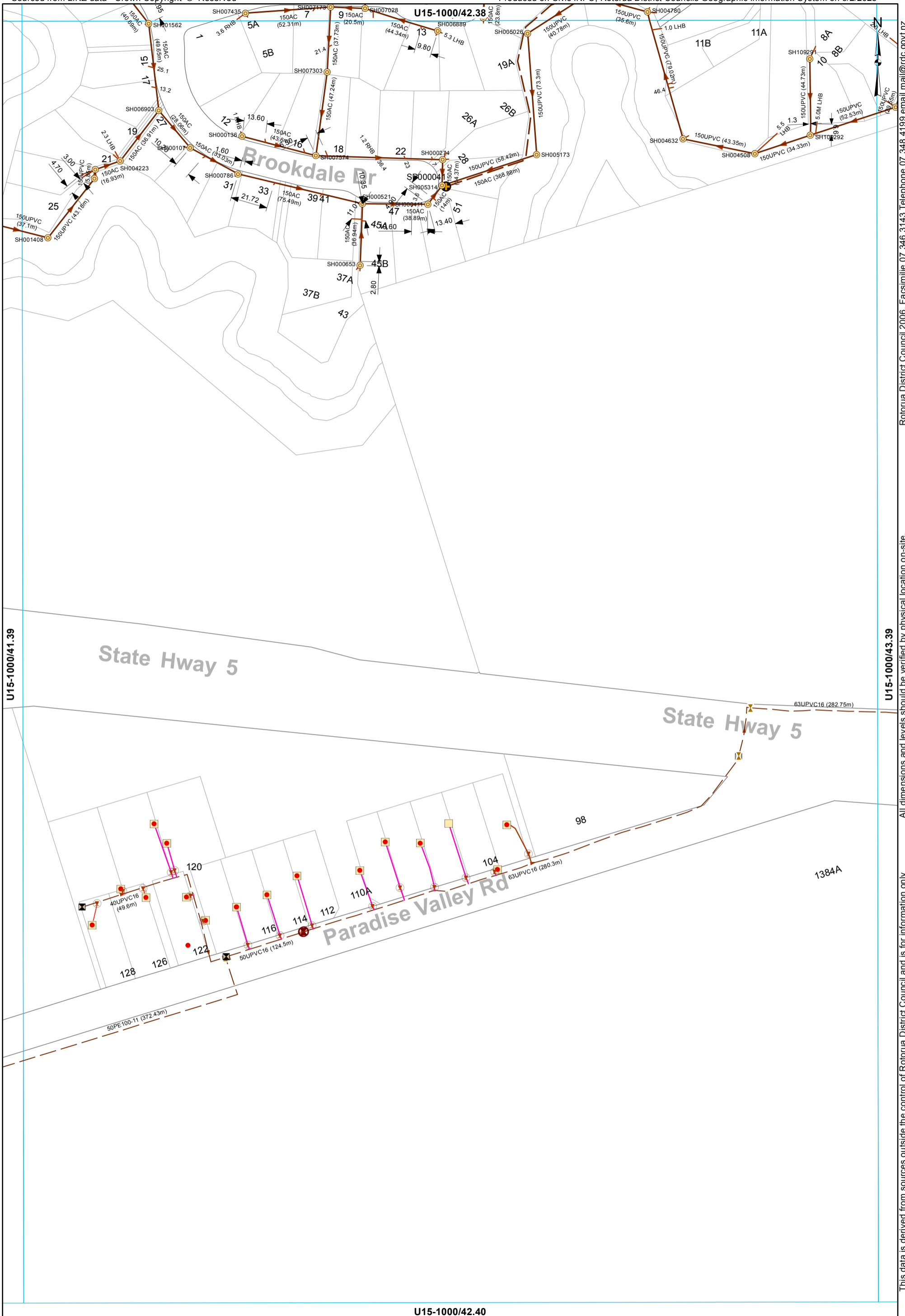

U15-1000/41.39

U15-1000/43.39

U15-1000/42.40

- Manhole
- ⊕ Pump Station
- Grinder Pump Chamber
- LP Grinder Pump
- ⊗ Air Valve
- ⊠ Boundary Assembly
- ⊞ Clean Out Point
- ⊡ Isolating Valve
- Low Pressure Main
- Main line
- Rising main
- Unknown Service Line
- Service Line
- LPGP Service Line

**WASTEWATER SERVICES**  
1:2000 @ A3 - (U15-1000/42.39)

This data is derived from sources outside the control of Rotorua District Council and is for information only

Rotorua District Council 2006. Facsimile 07 346 3143 Telephone 07 348 4199 email mail@rdc.govt.nz

U15-1000/43.38

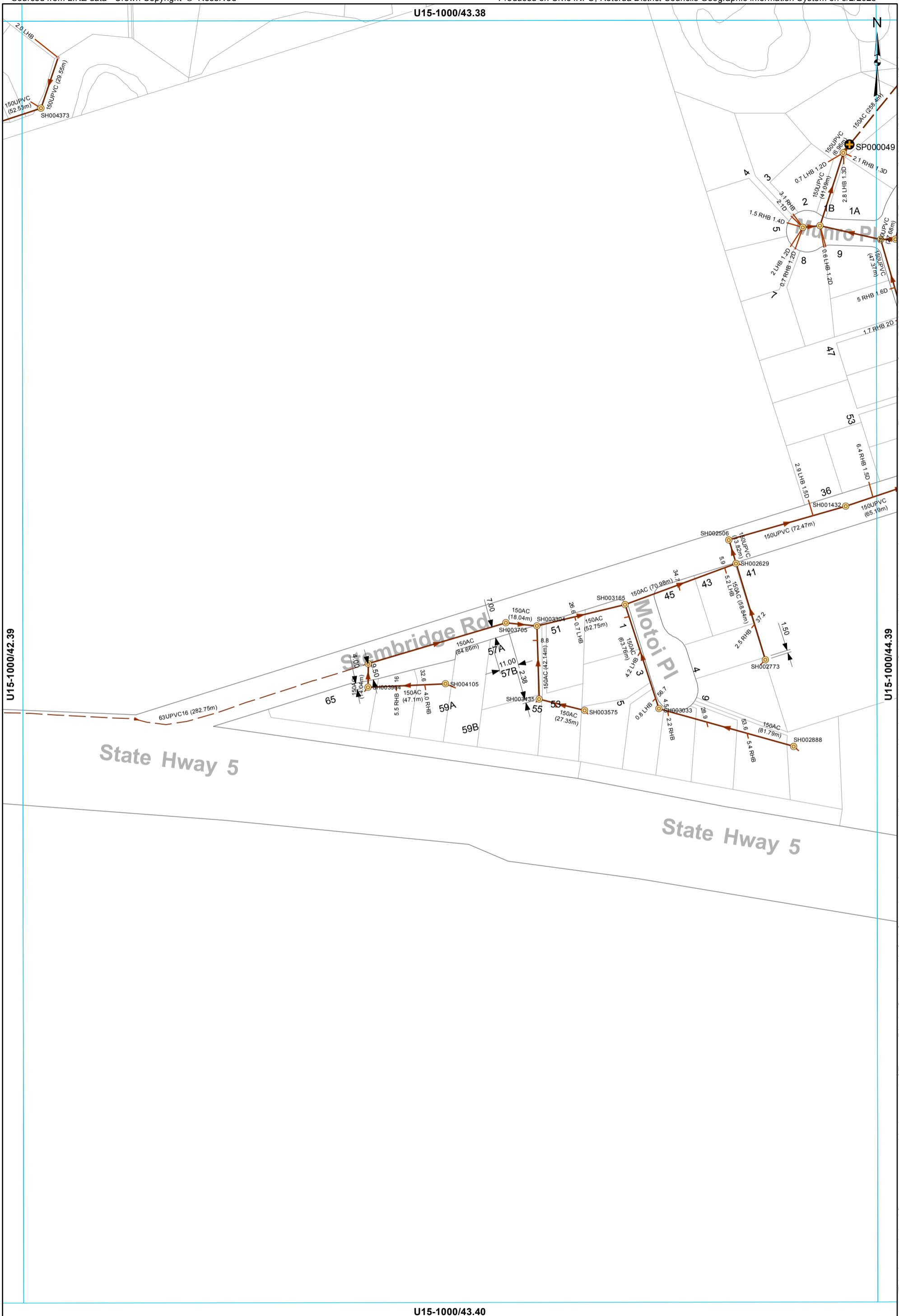

Rotorua District Council 2006. Facsimile 07 346 3143 Telephone 07 348 4199 email mail@rdc.govt.nz

All dimensions and levels should be verified by physical location on-site.

This data is derived from sources outside the control of Rotorua District Council and is for information only

U15-1000/43.40

- Manhole
- ⊕ Pump Station
- Inspection point
- Low Pressure Main
- Main line
- Rising main
- Service Line

**WASTEWATER SERVICES**  
1:2000 @ A3 - (U15-1000/43.39)





Rotorua District Council 2006. Facsimile 07 346 3143 Telephone 07 348 4199 email mail@rdc.govt.nz

All dimensions and levels should be verified by physical location on-site.

This data is derived from sources outside the control of Rotorua District Council and is for information only

- Manhole
- Chamber - Inspection
- Main line
- Rising main
- Service Line

U15-1000/44.40

**WASTEWATER SERVICES**  
**1:2000 @ A3 - (U15-1000/44.39)**



This data is derived from sources outside the control of Rotorua District Council and is for information only

Rotorua District Council 2006. Facsimile 07 346 3143 Telephone 07 348 4199 email mail@rdc.govt.nz

- Manhole
- Chamber - Inspection
- End of line - Capped end
- ⊗ Air Valve
- Private Asset
- Main line
- - Rising main
- Service Line
- LPGP Service Line

**WASTEWATER SERVICES**  
1:2000 @ A3 - (U15-1000/45.39)

U15-1000/46.38



Lake Rotorua

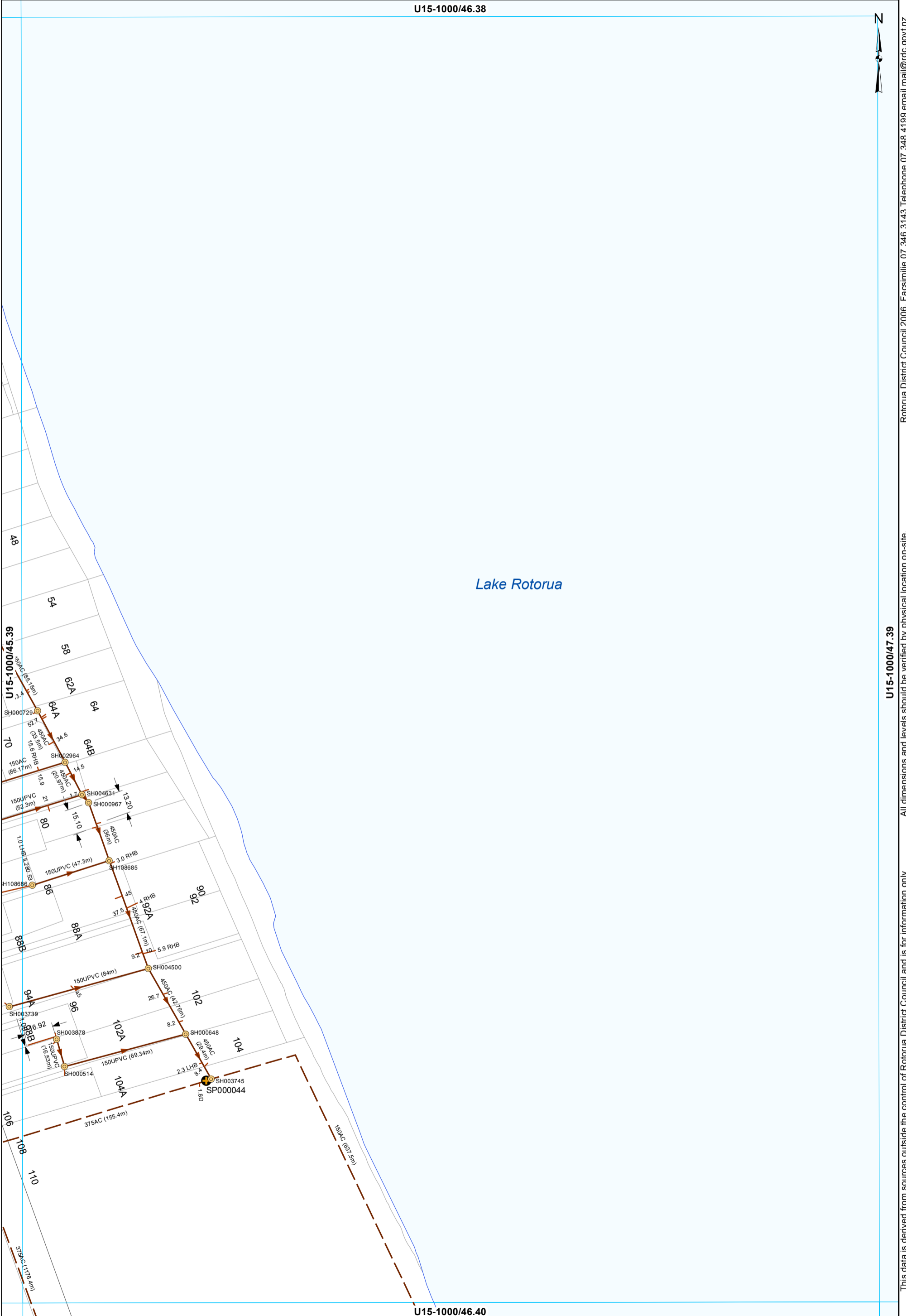

- Manhole
- Pump Station
- Main line
- Rising main
- Service Line

**WASTEWATER SERVICES**  
1:2000 @ A3 - (U15-1000/46.39)

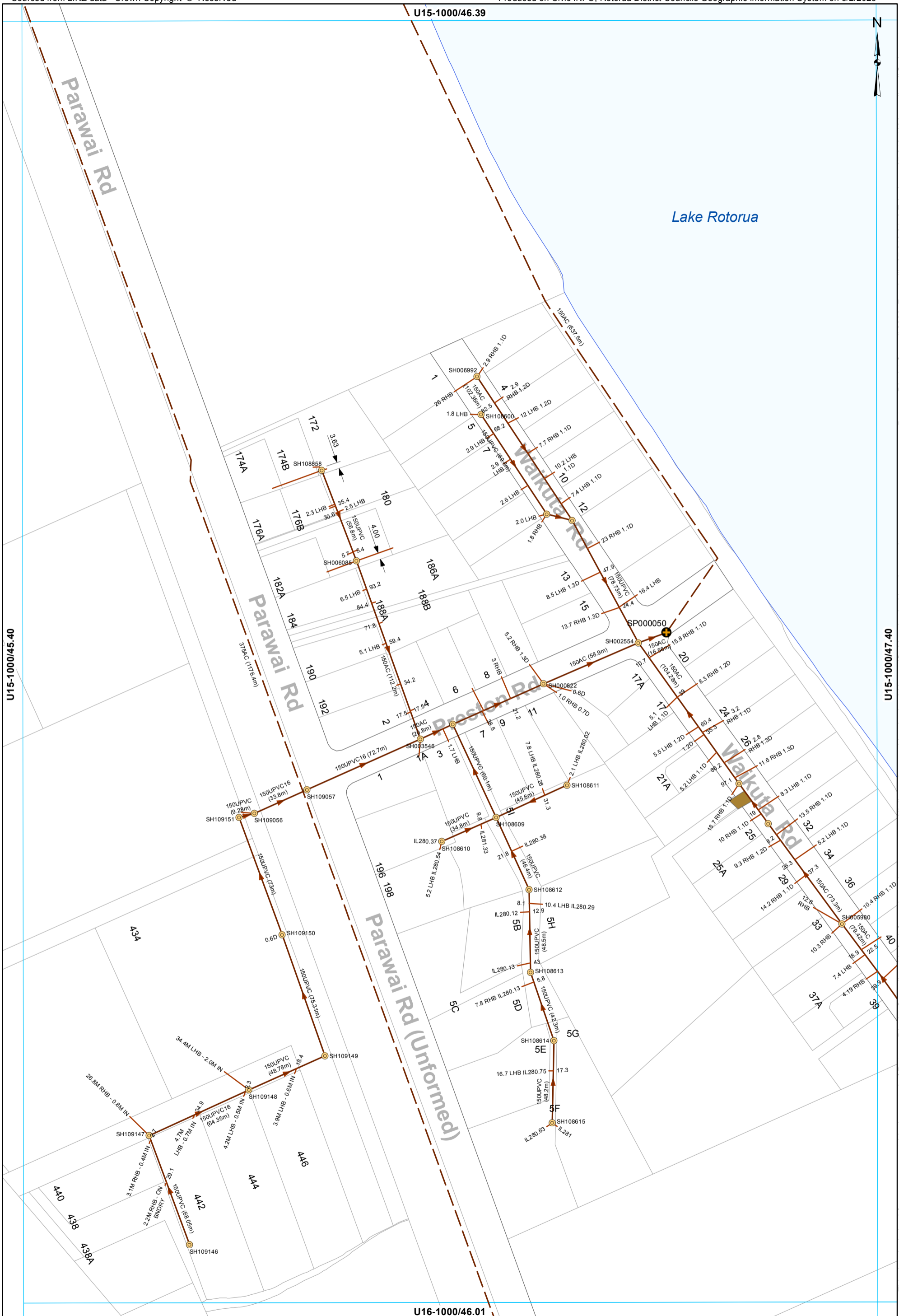

- Manhole
- Pump Station
- Main line
- Rising main
- Service Line

**WASTEWATER SERVICES**  
**1:2000 @ A3 - (U15-1000/46.40)**

All dimensions and levels should be verified by physical location on-site. Rotorua District Council and is for information only. Rotorua District Council 2006. Facsimile 07 348 3143 Telephone 07 348 4199 email mail@rdc.govt.nz

U15-1000/47.39



Lake Rotorua

U15-1000/46.40

U15-1000/48.40



This data is derived from sources outside the control of Rotorua District Council and is for information only. All dimensions and levels should be verified by physical location on-site.

Rotorua District Council 2006. Facsimile 07 346 3143 Telephone 07 348 4199 email mail@rdc.govt.nz

U16-1000/47.01

- Manhole
- Main line
- Service Line

**WASTEWATER SERVICES**  
1:2000 @ A3 - (U15-1000/47.40)

U15-1000/46.40



Ngongotaha Rd

A65

A64

U16-1000/45.01

504

506

508

Ngongotaha Rd

525

544

542

536

534

532

530

528

526

524

520

518

516

522

538

U16-1000/46.02

U16-1000/47.01

U16-1000/47.01

⊗ Air Valve - Rising main

WASTEWATER SERVICES  
1:2000 @ A3 - (U16-1000/46.01)

This data is derived from sources outside the control of Rotorua District Council and is for information only

All dimensions and levels should be verified by physical location on-site.

Rotorua District Council 2006. Facsimile 07 346 3143 Telephone 07 348 4199 email mail@rdc.govt.nz

U15-1000/47.40



Lake Rotorua

U16-1000/46.01

U16-1000/48.01

Rotorua District Council 2006. Facsimile 07 346 3143 Telephone 07 348 4199 email mail@rdc.govt.nz

All dimensions and levels should be verified by physical location on-site.

This data is derived from sources outside the control of Rotorua District Council and is for information only

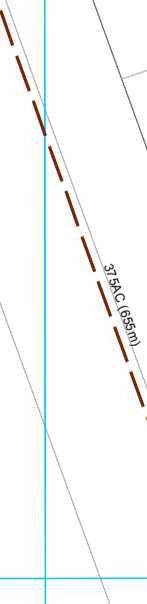

— Rising main

U16-1000/47.02

**WASTEWATER SERVICES**  
1:2000 @ A3 - (U16-1000/47.01)

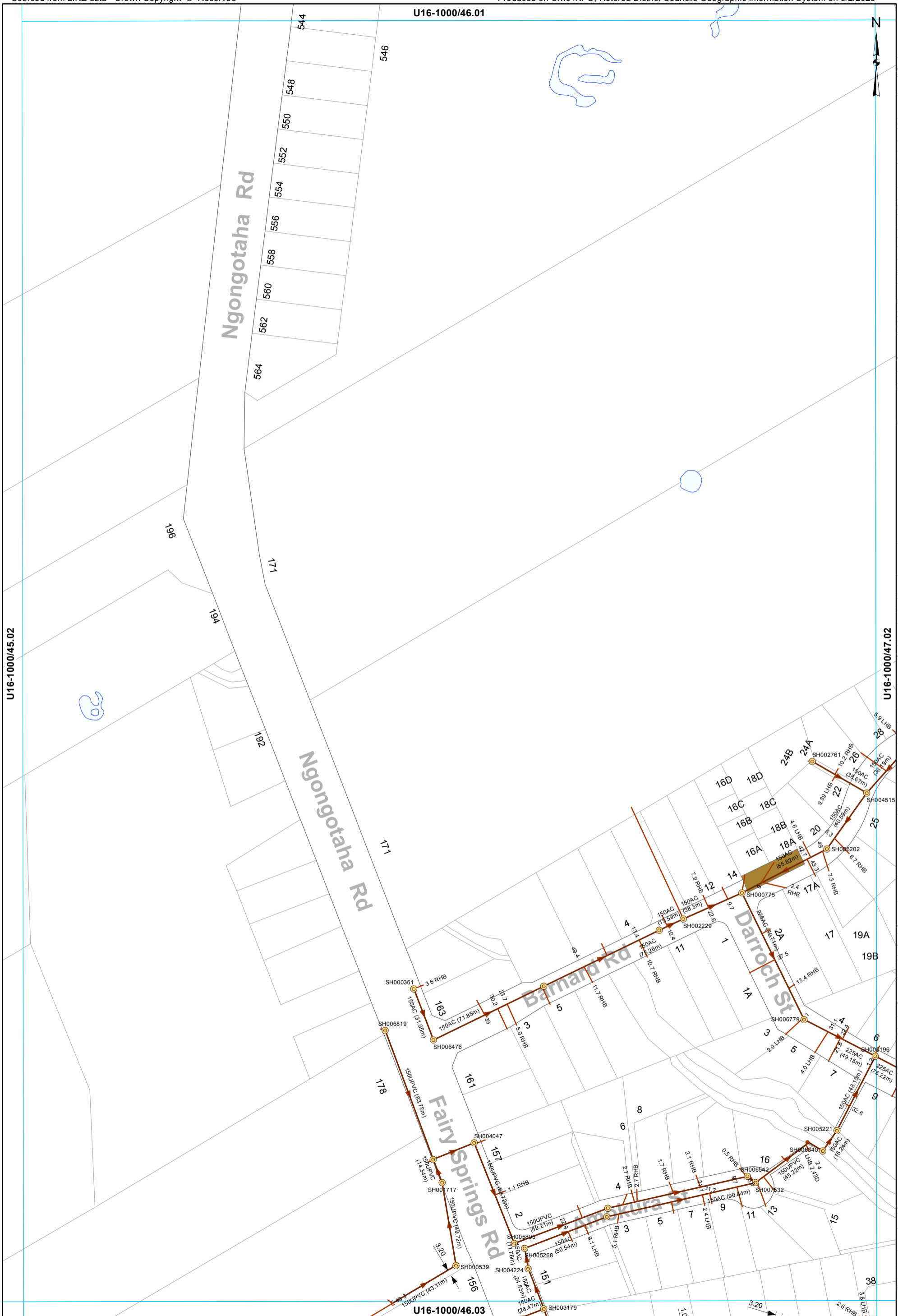

- Manhole
- End of line - Capped end
- End of line - Cleaning eye
- Main line
- Service Line

**WASTEWATER SERVICES**  
**1:2000 @ A3 - (U16-1000/46.02)**

This data is derived from sources outside the control of Rotorua District Council and is for information only

All dimensions and levels should be verified by physical location on-site.

Rotorua District Council 2006. Facsimile 07 346 3143 Telephone 07 348 4199 email mail@rdc.govt.nz